

VACATIONER/VACATIONER XE

2018 HOLIDAY RAMBLER
CLASS A GAS



HOLIDAY RAMBLER
REV GROUP

VACATIONER XE

TOP FEATURES

- (2) Roof-Mounted, High-Efficiency Ducted, 13,500-BTU Heater w/Chill Grille
- Auto Generator Start
- Drop-Down Queen Bed
- Manual Day/Night Roller Shades Throughout
- Side-View Cameras
- 40" Flat-Screen LED TV (Living Area)
- Residential Refrigerator
- 50-Amp Electrical Service & Power Cord w/1,200-watt Inverter (32A, 34S)
- 50-Amp Electrical Service & Power Cord w/2,000-watt Inverter (36D, 36F)
- Exterior Kitchenette w/Mini Fridge, Microwave, Cabinet Storage, and Pull Out Counter Surface (36D)



Vacationer XE 36F in Kona Grove décor with Italian Sienna High Gloss wood cabinetry.



This is living.

The 2018 Vacationer XE was built for Holiday Rambler owners looking for the finer things in life. A soft-touch sofa in the living area helps you relax in front of a 40" flat-screen LED TV, while a queen or king-size bed (depending on the model) with underneath storage and overhead reading lights awaits you in the master bedroom. With four floorplans available, you're sure to find the whole coach solid-surface countertops and day/night double roller shades perfect additions to an already welcome retreat.

VACATIONER XE FLOORPLANS

32A

Options: 105, 113, 126, 186

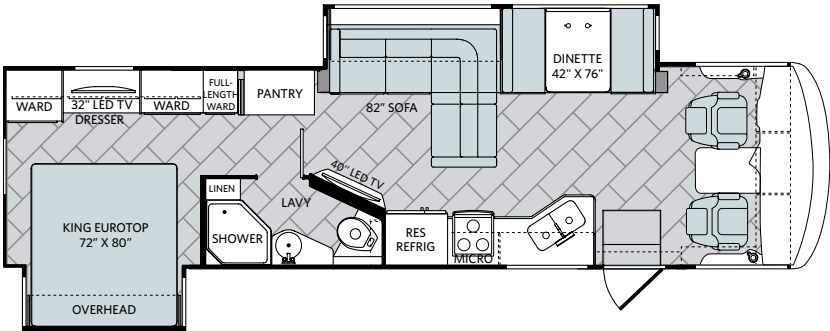

34S

Options: 105, 113, 126, 186

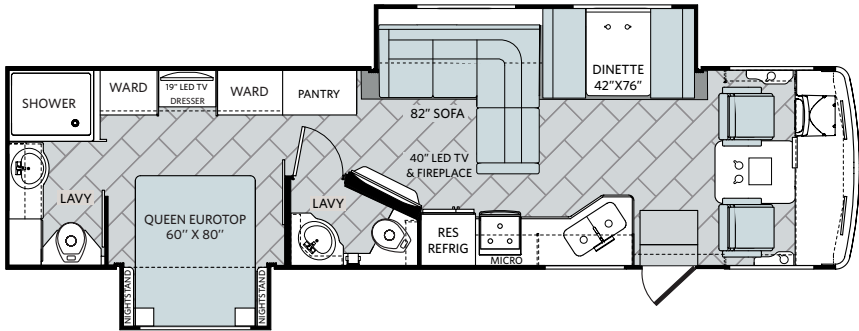

36D

Options: 113, 186

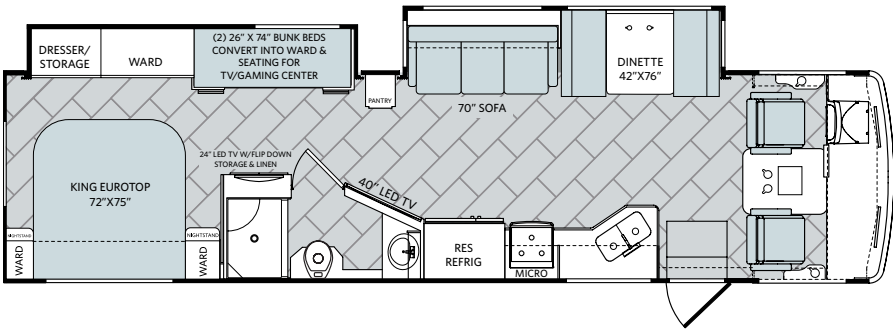

36F

Options: 113, 126, 186

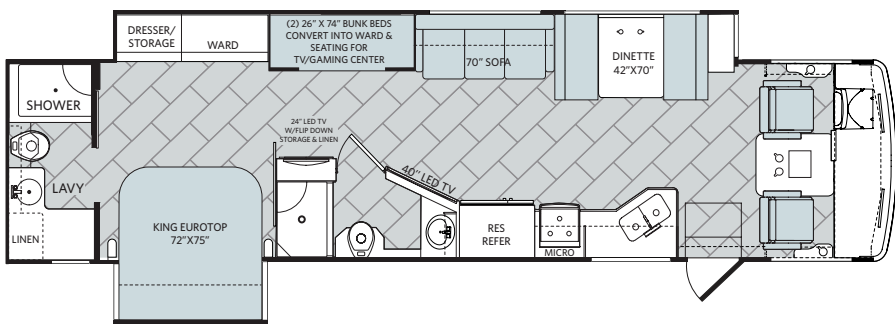

Available Options

OPT. 105
TWO DOOR REFRIG
W/ICE MAKER

OPT. 113
3-BURNER
COOKTOP
W/OVEN

OPT. 126
WASHER/DRYER

OPT. 186
DRIVER/PASSENGER
PEDESTAL TABLE

VACATIONER XE STANDARDS AND OPTIONS

INTERIOR THROUGHOUT

- 12V Water Pump, On Demand
- 12V USB Charging Outlets Throughout
- 10 Gallon Propane Water Heater w/Electronic Ignition
- (2) 13,500 Btu/h Ducted Air Conditioner w/Chill Grill
- 20,000/30,000 Btu/h Furnace (34S, 36F)
- 34,000/20,000 Btu/h Furnace (36D)
- 34,000 Btu/h Single Furnace (32A)
- AC/DC Load Center
- Accent Panel w/Chair Rail (Select Models)
- Auxiliary Batteries w/Disconnect Switch
- Energy Efficient LED 3" Puck Flush Mount Lighting
- 1200 Watt & Inverter, 60 AMP Converter Power (32A & 34S)
- 2000 Watt & Inverter, 100 AMP Converter Power (36D & 36F)
- Dedicated Full-Length, Metallic A/C Ducting
- Deluxe Roller Bearing, Full Extension Drawer Guides & Transit-Ship Locks
- Fantastic® Power Vent w/Wall (Multiple Locations)
- Generator Auto Changeover
- Hide-A-Loft Drop Down Queen Bed
- Interior Soft-Touch Vinyl Ceiling w/Ducted Air
- Hardwood Crown Molding Throughout at Ceiling
- Hardwood Fascia
- Hardwood Drawers
- Hardwood Raised Panel Cabinet Doors Upper & Lower w/Hidden Hinges
- Manual Day/Night Double Roller Shades Throughout Black
- Ozite Lined Shelves in Overhead Cabinets
- Polished Solid Surface Countertops
- Single Location Monitor Panel w/ LPG, Battery Disconnect Switches, Tank Level & Battery Readout
- Tuff-Pex™ Plumbing System
- Whole Coach Water Filtration System
- Water Heater Bypass Valve
- Fresh Water System Winterization
- Vinyl Flooring
- Water Pump w/On/Off Switches at Monitor Panel & Lavvy
- Window Treatments
- OPTIONS**
- CSA Package (Canadian Specs)**
- Satellite Radio (Subscription Required)

DRIVER CONVENIENCE

- 110-Volt AC Outlet at Passenger Area
- 12V & USB Accessory Ports
- Auto Generator Start System
- Auxiliary Emergency Start Assist Switch on Dash
- Dash Radio - 6" Jensen Touch Screen & Premium Sound System w/AM/FM/CD/DVD/Bluetooth Including USB & Aux Inputs
- Driver Captains Chair – Soft Touch w/Reclining Back, Swivel & 6-Way Power Controls – Lexington
- Driver Side Console w/Integrated Magazine Rack & Solid Surface Top
- Driver/Passenger Cup Holders, Reading Lights, Sun Visors, Power Roller Shade & Manual Day/Night Black Roller Shades
- Electronic Cruise Control
- High Output Dash Heat & Air Conditioning
- Intense Halogen Projector Headlamps
- Passenger Captains Chair - Lexington Soft Touch w/Reclining Back & Swivel
- Passenger Armrest w/Integrated Magazine Rack, Cup Holder & Solid Surface Top
- Power Heated Mirrors w/Remote Switch
- Radio Switch Main/Auxiliary Power
- Rear Vision Cameras Mounted Into Rearview Mirrors
- Seat Belts - 3 Point Driver & Passenger w/Adjustable Straps
- Steering Wheel w/Tilt
- Windshield Wipers w/Delay
- OPTIONS**
- Driver/Passenger Pedestal Table
- Premium Radio Upgrade

LIVING ROOM

- 40" Flat Screen LED TV
- Electric Fireplace (32A, 34S, 36D)
- Sofa - Soft Touch Lexington L-Sofa w/Footrest & Air Bed (32A, 34S)
- Jack-Knife Sofa - Soft Touch Lexington (36D, 36F)
- Soft Touch Dream Dinette w/Large Drawers

GALLEY

- 3 Burner Range w/High Output w/Cooktop Cover
- 1000W Stainless Steel Convection Microwave Oven w/Electronic Touch Pad
- Adjustable Shelves
- Deep Double Bowl Under-Mount Stainless Steel Sink
- Glass Tile Backsplash
- Polished Solid Surface Countertops, Sink & Stove Top Covers
- Power Ceiling Vent Fan
- Refrigerator - 11 cu. ft. Residential Stainless Steel (32A, 34S)

GALLEY continued

- Refrigerator – 18 cu. Ft. Residential Stainless Steel w/2000W Pure Sine Inverter w/Remote (36D, 36F)
- Residential Single Handle Faucet w/Pullout Sprayer
- Satin Nickel Finish Cabinet Hardware
- Sink Cover/Cutting Board
- Slide-Out Dinette Bins w/Latches
- Toe Kick at bottom of Cabinets
- Waste Basket
- OPTIONS**
- 3-Burner Range w/Oven ILO Drawers
- Refrigerator - 8 cu. ft. 2-Door Wood Insert - Dometic (32A, 34S)

BEDROOM

- 24" Bunk Area LED TV w/Remote DVD, Game System, & Satellite Receiver Connections (36D, 36F)
- 32" Bedroom LED TV w/Connections To Add Satellite Receiver and DVD (32A)
- 19" Bedroom TV (34S)
- Bedsread w/Integrated Shams & Accent Pillows
- Bunk Bed w/Privacy Curtains (36D, 36F)
- Bunk Beds w/5" Foam Mattress (36D, 36F)
- Designer Headboard
- King Size Dream Easy Mattress (32A, 36D, 36F)
- Lift Up Bed w/Under Bed Storage
- Queen Size Dream Easy Mattress (34S)
- Reading Lights in Bed Overhead Cabinet
- Remote Generator Start Switch
- Solid Surface Nightstand Tops
- OPTIONS**
- Washer/Dryer Combo (32A, 34S, 36F)

BATHROOM

- Accessories: Towel Bar & Toilet Paper - Satin Nickel
- Bath Door w/Residential Passage Lock
- Deluxe Hardwood Medicine Cabinet w/Mirror
- Fiberglass Shower
- Glass Shower Door - Rain Glass
- Metal Shower Head w/On/Off, Sliding Adjustable Bar, Soap Dish & Matching Dual Valve Faucet
- Residential Brushed Nickel Single Handle Faucet w/Large Sink
- Residential Porcelain and/or Stainless Steel Lavvy Sink
- Residential Water Saver & Vacu-Flush Porcelain Toilet
- Shower Skylight/Roof Vent w/12V Fan

SAFETY/CONVENIENCE

- 10 lb. ABC Fire Extinguisher
- Battery Access Entry Step Cover
- Battery Disconnect
- Carbon Monoxide, Propane, & Smoke Detectors/Alarms
- Egress Windows
- Entry Door Manual Roller Shade
- Exterior & Interior Entry Assist Handle
- GFI Circuit Protection
- Master Light Switch at Entry For All Storage Compartments
- Multiple Seatbelt Locations
- Steel Constructed Entry Step Box w/Rubber Entry Step

EXTERIOR THROUGHOUT

- ABS Wheel Well Skirts
- Jack Antenna
- Automotive Style Soft Dash
- Automotive Style Windshield Wiper System
- Awning - Single Wall Mounted Legless Patio Awning w/LED Lighting & Wind Sensor Retract
- Awning - Slide Out Toppers Above All Slide Outs
- (4) 6V Deep Cycle House Batteries
- Black Instrument Gages w/ Electronic Information Center
- Black Water Tank Flush
- Corrosion Resistant Steel Luggage Door Hinges
- Deadbolt Lock & Frameless Window
- Door Side Area Patio Light
- Driver Side Area Patio Light Above Service Center
- Entrance Door - Radius Trimmed Door w/Black Interior & Black Screen Door, w/Rotary Latch
- Exterior Lighted Power Entry Step
- Exterior Kitchenette w/Mini Fridge, Microwave, Cabinet Storage, and Pull Out Counter Surface (36D)
- Exterior Service Station - Including Water Pump Switch, Exterior Shower, Black Tank Flush, City Water Hookup & Drainage Valves
- Exterior Wall Mounted Entertainment Center – w/32 LED TV, AM/FM/CD/DVD Radio
- Front/Rear Clearance & Marker Lighting
- Front/Rear Mud Flaps
- Formed Grille & Air Intake
- Gravity Water Fill
- Hitch - Capacity of 5,000# w/7-Way Round Tow Connection
- Intense Halogen Projector Headlamps w/LED Accents Large Lighted Roto-Molded
- Polyethylene Compartments
- One Piece TPO Domed Roof
- 4-Color Premier Full-Body Paint
- Fiberglass Aerodynamic Front Cap w/Automotive Head Lighting, Seamless Mounting, & Hood Insert
- Fiberglass Rear Cap w/Automotive Lighting
- Side-Swing, Insulated Aluminum Luggage Doors w/Single Paddle Latch
- Tinted Slider Driver & Passenger Windows
- Under-hood Utility Light
- 12V 3GPM High Capacity Shurflo Water Pump
- Large Dark Tinted Frameless Single Pane
- OPTIONS**
- DSS Auto-Locating Stationary Satellite Dish - Wineguard
- Dual Glazed Windows
- Neutral Loss Protection
- Tankless Water Heater
- King Stationary Satellite System
- Roof Vent Rain Cover

SAFETY/CONVENIENCE

- 50 Amp Electrical Service & 30' Power Cord
- AC Duplex GFI Receptacle on Patio Side
- Acrylic Grab Handle at Entry Door
- Amber Porch Light w/Interior Switch
- Automatic Hydraulic Leveling Jacks
- Automotive Safety Glass
- Daytime Running Lights
- Entry Door w/Screen Door & Deadbolt Lock
- High Mounted Large LED Taillights
- Power Electric Step
- Radius Tinted Windows

STORAGE

- Molded Cross Link Polyethylene Battery Compartment w/Lid
- Pass Through Storage
- Rotocast Molded Storage Boxes

BODY STRUCTURE

- Basement Storage Lighting w/ Master Switch Inside Entry
- Corrosion Resistant Aluminum Tube Hull Framing
- Dryseal™ Edge Coating Water-Wicking Wall Edge Coating
- Electric Slide Out Systems
- Ford 22,000lb Chassis w/320HP V10
- Full Coverage Heavy Duty Undercoating
- Full Pass Through Storage w/Roto-Molded Construction
- Heated Fresh Water & Holding Tank Compartments
- Molded Entry Step
- Powder & Liquid Coated Steel Frame Chassis Construction
- Powerframes™ Precision Welding w/5-Point Build System
- Powerlock System™ w/Interlocking Floor, Walls & Ceiling
- Radiused Entry Door
- Raised Space Frame Foundation
- Rotational Molded Easy To Clean Service Compartment
- Solid Bead-Foam Engineered Fit Insulation™
- Vacu-Bond™ Aluminum Framed Sidewalls, Roof & Floor Construction

VACATIONER

TOP FEATURES

- Solid Surface Tops & Glass Tile Backsplash (Galley)
- IllumaPlex™ Electronic Control System w/App Control
- Auto Generator Start
- Power Driver Seat
- Recessed Cooktop w/Solid Surface Covers
- Oversized Window(s) in Galley and Living Room
- Stainless Steel Convection Microwave Oven
- Exterior Entertainment Center
- Residential Refrigerator
- Electric Fireplace (NA on 35P)

LX PACKAGE

- Solid Surface throughout (added to nightstands, side table, and end tables)
- Onan 7.0 Generator
- 2nd 15K Btu/h AC w/Heat Pump (front AC - in addition to the rear AC)
- Chrome Side Mirrors
- Chrome Luggage Door Handles
- Power Cord Reel
- Undercarriage Lighting (Doorside & Front)



Vacationer 35K in Bittersweet décor with Italian Sienna High Gloss wood cabinetry.



This is living.

For Holiday Rambler owners, every day is a vacation. This is truer than ever with the 2018 Vacationer, a mid-priced Class A gas made for full-time RV living. RV bliss begins in the galley with a large window, residential refrigerator and stainless-steel convection microwave oven. And what's not to love about the RV life when you can enjoy it sitting in front of the living room's electric fireplace or under the legless patio awning watching your favorite movies at the exterior entertainment center.

VACATIONER FLOORPLANS

33C

Options: 113, 126, 833, 852

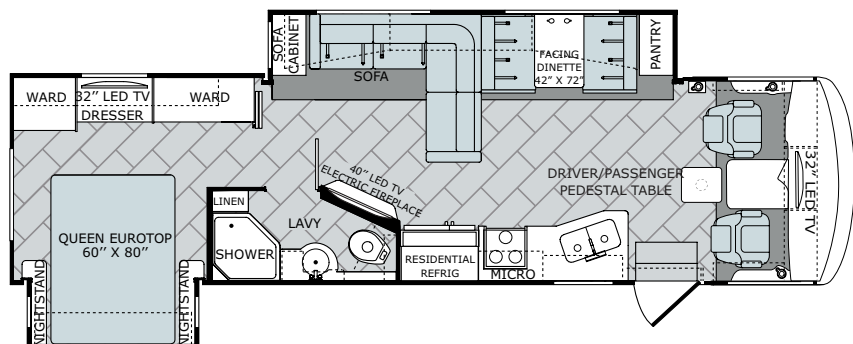

35K

Options: 113, 126, 833, 852

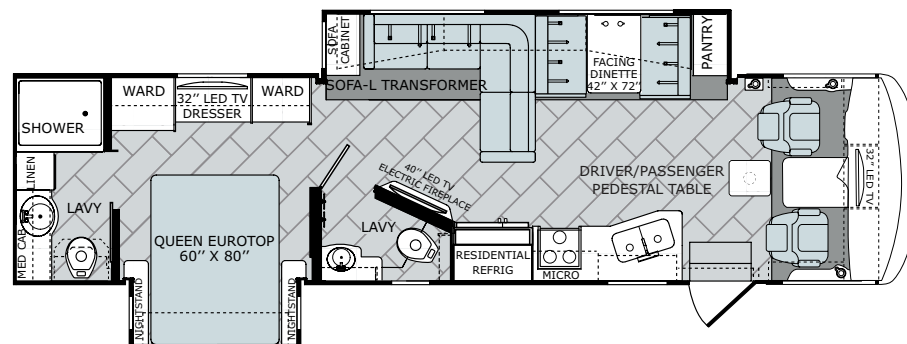

35P

Options: 113, 131, 208, 833

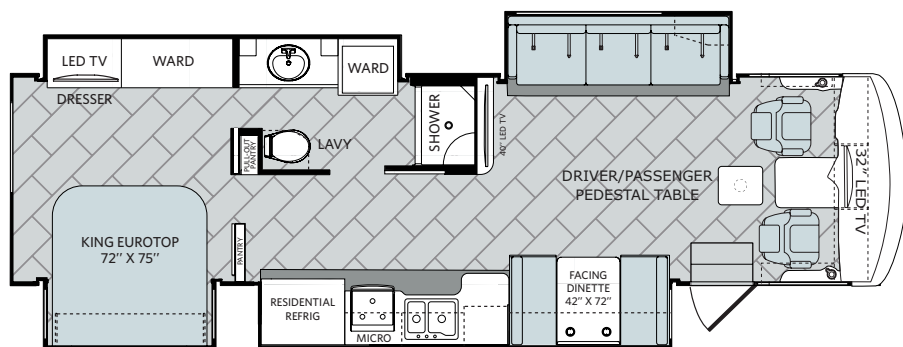

36H

Options: 113, 126, 833, 852

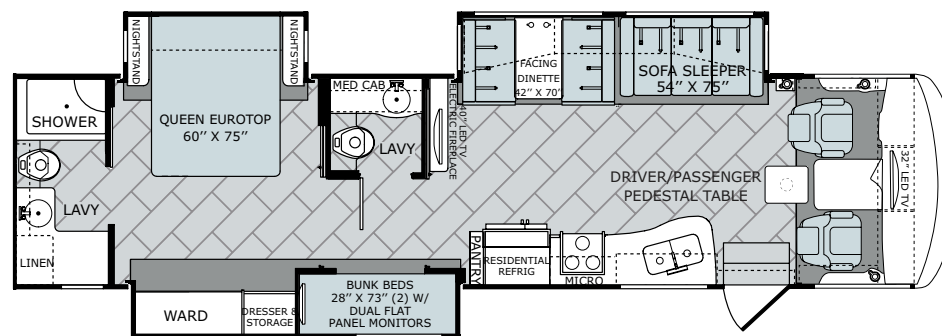

Available Options



OPT. 113
3-BURNER
COOKTOP
W/OVEN



OPT. 126
WASHER/DRYER
(33C, 35K, 36H)



OPT. 131
STACKABLE
WASHER/DRYER
(35P ONLY)

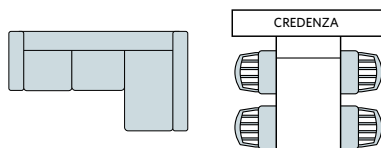

OPT. 208
L-SOFA W/FREE-STANDING DINETTE
W/CREDENZA (35P ONLY)

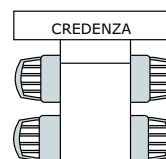

OPT. 833
FREE-STANDING DINETTE
WITH CREDENZA

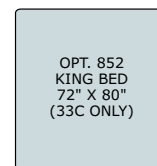

OPT. 852
KING BED
72" X 80"
(33C ONLY)

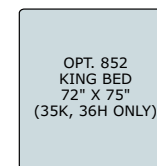

OPT. 852
KING BED
72" X 75"
(35K, 36H ONLY)

VACATIONER STANDARDS AND OPTIONS

INTERIOR THROUGHOUT

- 100-Gallon Fresh Water Holding Tank
 - 10-Gallon Quick Recovery Water Heater w/Direct Spark Ignition (Gas/Electric)
 - 120V/12V AC/DC Converter
 - 13,500 Btu/h Front A/C
 - 13,500 Btu/h Rear A/C w/Heat Pump
 - 30,000/20,000 Btu/h Furnace (33C, 35K, 35P)
 - 34,000 Btu/h Furnace (33C, 35K, 35P)
 - Blu-ray® Home Theater Sound System (33C, 35K, 36H)
 - Mid TV Sound Bar (35P)
 - Deluxe Roller Bearing, Full Extension Drawer Guides & Transit-Ship Locks
 - Demand Water Pump w/Filter
 - Dual Roof A/C High-Efficiency w/Solar Panel, Chill Grills & Bedroom Heat Pump
 - Energy Efficient LED 3" Puck Flush Mount Lighting Throughout
 - Energy Management System
 - Fabric Window Treatments w/Wood Accents Throughout
 - Fan-Tastic® Power Roof Vent (Multiple Locations)
 - Flat Interior Ceiling
 - Full HD Video System
 - Full-Length, Metallic A/C Ducting
 - Hardwood Crown Molding
- Throughout at Ceiling
- Hardwood Raised Panel Cabinet Doors Upper & Lower w/Hidden Hinges
 - Hardwood Fascia
 - IllumaPlex™ Electronic Control System w/App Control
 - Interior Soft-Touch Vinyl Ceiling w/Ducted Air
 - Ozite Lined Shelves
 - Polished Solid-Surface Countertops (Galley & Lavy)
 - Manual Day/Night Double Roller Shades Throughout - Black
 - Tuff-Pex™ Plumbing System
 - TV Antenna w/Signal Booster
 - Vinyl Flooring
 - Wall Switches Panels
 - Water Heater Bypass Valve
 - Water Pump Switches in Multiple Locations
 - Whole-Coach Water Filtration System
 - Hardwood Drawers
 - Window Treatments
- OPTIONS**
- CSA Package (Canadian Specs)
 - Winegard® Stationary Satellite System
 - King Stationary Satellite System

DRIVER CONVENIENCE

- 110-Volt AC Outlet at Passenger Area
 - 12- Volt & USB Accessory Ports
 - AM/FM/DVD Touch Screen Radio w/CD Player, Satellite Radio-Ready Auto
 - A/C Heater Combo
 - Auto Generator Start System
 - Auxiliary Emergency Start Assist Switch on Dash
 - Battery Disconnect System
 - Dash Fans
 - Driver/Passenger Captain's Chairs w/Diamond Pattern Lumbar, Contrasting Baseball Stitch, Comfort Fit Foam Design, & Reclining Back/Swivel
 - Driver 6-Way Power Controls
 - Driver/Passenger Power Sun Visors, Power Roller Shade & Manual Day/Night Black Roller Shades
 - Driver/Passenger Cup Holders
 - Driver/Passenger Reading Lights
- Driver/Passenger Pedestal Table
- Dual Monitor Panel in Dash
 - Electronic Cruise Control
 - High Output Dash Heat & Air Conditioning
 - Intense Halogen Projector Headlamps
 - Power Heated Mirrors w/Remote Switch
 - Radio Switch Main/Auxiliary Power
 - Rear Vision Cameras Mounted Into Rear View Mirrors
 - Removable Cockpit Floormat
 - Seat Belts - 3-Point Driver & Passenger w/Adjustable Straps
 - Soft-Touch Automotive Dash
 - Steering Wheel w/Tilt
 - Windshield Wipers w/Delay
- OPTIONS**
- Premium Radio Upgrade

LIVING ROOM

- 32" LED HDTV in Front Overhead
 - Electric Fireplace (33C, 35K, 36H)
 - 40" LED HDTV (Storage Behind-Select Floor Plans)
 - Entry Assist Handle
 - Facing Dinette
 - Home Theater Sound System (33C, 35K, 36H)
 - Mid TV Sound Bar (35P)
- Oversized Windows
- Residential Seat Styling
 - Sofa w/Diamond Pattern Lumbar Contrasting Baseball Stitch & Comfort Foam Design
- OPTIONS**
- Free-Standing Dinette w/Credenza
 - L-Sofa / Free-Standing Dinette w/Credenza

GALLEY continued

- Adjustable Cabinet Shelves
 - Brushed-Nickel Finish Cabinet Hardware & Faucet
- Convenient Galley Slide-Out Cabinet w/Shelf (Select Floor Plans)

GALLEY

- Deep Double-Bowl Under-Mount Stainless-Steel Sink
 - Demand Water Pump
 - Large Slide-Out Dinette Drawers w/Latches - Under Dinette
 - Large Galley Window
 - Polished Solid Surface Countertops, Sink & Stove Top Covers
 - Power Ceiling Vent Fan
 - Recessed 3-Burner Cooktop
 - Residential Refrigerator w/Platinum Exterior
- Single-Lever Galley Faucet w/Pullout Sprayer
- Sink Cover/Cutting Board
 - Stainless Steel Convection Microwave Oven
 - Tile Backsplash w/Stainless Accents
 - Toe Kick
 - Wastebasket
- OPTIONS**
- 3-Burner Range w/Oven

BEDROOM

- 32" LED HDTV
 - Bedspread w/Integrated Shams & Accent Pillows
 - Designer Headboard
 - Dual Flat-Panel Monitors (36H)
 - Exclusive Dream Easy Mattress
 - Lift Up Bed w/Under Bed Storage
 - Reading Lights in Bed Overhead Cabinets
- Rear Speakers
- Remote Generator Start
 - Slide-Out w/2 Windows
 - USB Port/120V Outlet
- OPTIONS**
- King Bed (33C, 35K, 36H)
 - Washer/Dryer Combo (33C, 35K, 36H)

BATHROOM

- Accessories: Towel Bar & Toilet Paper Holders - Satin Nickel
 - Bath Door w/Residential Passage Lock
 - Deluxe Hardwood Medicine Cabinet w/Mirror
 - Metal Shower Head w/On/Off, Sliding Adjustable Bar, Soap Dish & Matching Dual Valve Faucet
 - Fiberglass Shower
 - Glass Shower Door - Rain Glass
 - Hardwood Bath Door/Trims
 - Residential Brushed Nickel Single Handle Faucet w/Large Sink
- Residential Sink
- Residential Water Saver & Vacu-Flush Porcelain Toilet (33C, 35K, 36H)
 - Skylight in Shower/Roof Vent w/12V Fan
 - Solid-Surface Countertops w/Solid-Surface Backsplash
 - Toilet Tank San-T-Flush™ System
 - Residential Water Saver & Porcelain Toilet (35P, 36H)
- OPTIONS**
- Stackable Washer/Dryer (35P)

SAFETY/CONVENIENCE

- 10-ABC Fire Extinguishers
 - Battery Access Entry Step Cover
 - Battery Disconnect
 - Carbon Monoxide, Propane & Smoke Detectors/sAlarm
 - Egress Windows
 - Entry Door Manual Roller Shade
- GFI Circuit Protection
- Exterior & Interior Entry Assist Handle
 - Master Light Switch at Entry For All Storage Compartments
 - Multiple Seatbelt Locations

EXTERIOR THROUGHOUT

- 2,000-Watt Pure Sine Inverter
 - 5.5 kW Onan® MicroQuiet Generator
 - 50-Amp Service
 - Fiberglass Wheel Well Skirts
 - Antenna - Unidirectional King Controls Jack Antenna
 - Automotive Style Soft Dash
 - Automotive Style Windshield Wiper System
 - Awning - Single Wall Mounted Legless Patio Awning w/LED Lighting & Wind Sensor Retract
 - Awning - Slide Out Toppers Above All Slide Outs
 - (4) 6V Deep-Cycle House Batteries
 - Black Instrument Gages w/Electronic Information Center
 - Black Water Tank Flush
- Corrosion Resistant Steel Luggage Door Hinges
- Daytime Running Lights
 - Deadbolt Lock & Frameless Window
 - Door Side Area Patio Light
 - Driver Side Area Patio Light Above Service Center
 - Entrance Door - Radius Trimmed Door w/Black Interior & Black Screen Door, w/Rotary Latch, Exterior Lighted Power Entry Step
 - Exterior Service Station - Including Water Pump Switch, Exterior Shower, Black Tank Flush, City Water Hookup
 - Neutral Loss Protection
 - One Piece TPO Domed Roof

EXTERIOR THROUGHOUT continued

- Exterior Wall Mounted Entertainment Center - w/32" LED TV, AM/FM/CD/DVD Radio
 - Drainage Valves
 - 4-Color Premier Full-Body Paint
 - Fiberglass Aerodynamic Front Cap w/Automotive Head Lighting, Seamless Mounting, & Hood Insert
 - Fiberglass Rear Cap w/Automotive Lighting
 - Formed Grille & Air Intake
 - Front/Rear Mud Flaps
 - Front/Rear LED Clearance & Marker Lighting
 - Gravity Water Fill
 - Hitch - Capacity of 5,000 # w/7-Way Round Tow Connection
 - Large Lighted Roto-Molded Polyethylene Compartments Latch Rods
- Protective Front Mask
- Premium Full-Body Paint
 - Prep for Roof-Mounting Satellite Dish
 - Side-Swing, Insulated Aluminum Luggage Doors w/Single Paddle Latch
 - Solar Electrical Panel Prep
 - Surge Guard Transfer Switch
 - Tinted Slider Driver/Passenger Windows
 - Under-hood Utility Light
 - 12V 3GPM High Capacity Shurflo Water Pump
 - Large Dark Tinted Frameless Dual Pane Windows Throughout
- OPTIONS**
- Rear Ladder
 - Roof Vent Rain Cover

AUTOMOTIVE

- 4-Point Automatic Levelers
- Trailer Hitch w/7-Pin Electrical Hook-Up

LX PACKAGE

- Onan® 7.0kW Generator
 - 15,000 Btu/h w/Heat Pump Front A/C
 - Door Side & Front Undercarriage Lighting
 - Power Cord Reel
- Exterior Chrome Package (Luggage Compartment Handles & Mirrors w/Side View Cameras)
- Solid Surface Countertops Throughout

SAFETY/CONVENIENCE

- Amber Porch Light w/Interior Switch
 - Automatic Hydraulic Leveling Jacks
 - Automotive Safety Glass
 - Color Rear-Vision Camera w/One-Way Audio
 - Daytime Running Lights
 - Entry Door w/Screen Door & Deadbolt Lock
 - High Mounted Large Taillights
 - Hydraulic 4-Wheel Disk Brakes w/4-Wheel ABS
- Lighted Entry Assist Handle
- Power Electric Step
 - Radius Tinted Windows
 - Under-hood Utility Lights
 - Utility Compartment w/Exterior Shower

STORAGE

- Continuous One-Piece Compartment Bulb Seal
- Pass-Through Storage (Select Models)
- Rotocast Molded Storage Boxes

BODY STRUCTURE

- Aluminum Bus-Style Side Swing Luggage Doors
 - Basement Storage Lighting w/Individual Switches and Master Switch Inside Entry
 - Corrosion Resistant Aluminum Tube Hull Framing
 - Dryseal™ Edge Coating Water-Wicking Wall Edge Coating
 - Electric Slide Out Systems
 - Full Coverage Heavy Duty Undercoating
 - Full Pass Through Storage w/Roto-Molded Construction
 - Heated Fresh Water & Holding Tank Compartments
 - Steel Constructed Entry Step Box
- Powder & Liquid Coated Steel Frame Chassis Construction
- Power Platform® Construction
 - Powerframes™ Precision, Welded
 - Aluminum Interlocking Frames
 - Powerlock System™ (Interlocking Floors, Walls, & Ceiling)
 - Radiused Entry Door
 - Raised Space Frame Foundation
 - Rotational Molded Easy To Clean Service Compartment
 - Solid Bead-Foam Engineered Fit Insulation™
 - Vacu-Bond™ Aluminum Framed Sidewalls, Roof & Floor Construction

DÉCOR & EXTERIOR OPTIONS

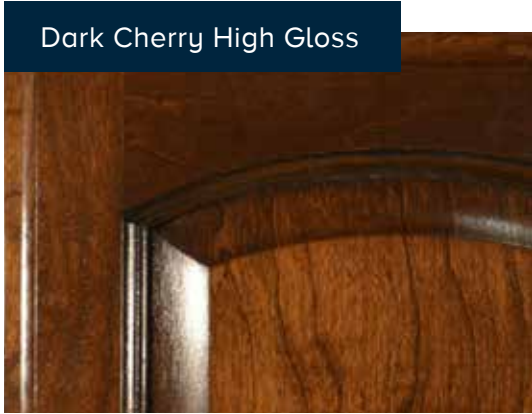

1 | Sofa 2 | Accent 3 | Bedspread 4 | Countertop 5 | Flooring 6 | Carpet

VACATIONER XE

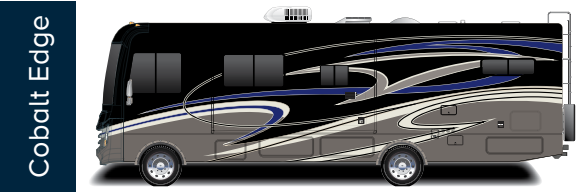
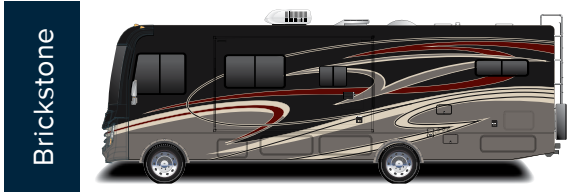

VACATIONER

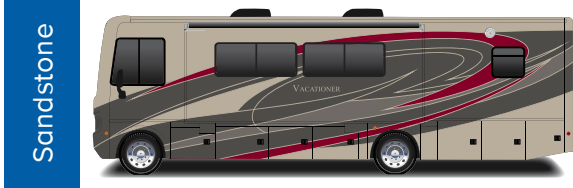
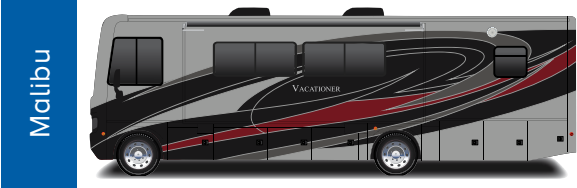
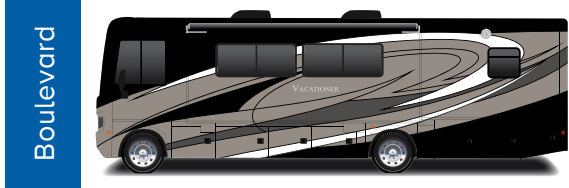

WEIGHTS AND MEASUREMENTS

CHASSIS

MODEL	VACATIONER XE				VACATIONER			
	32A	34S	36D	36F	33C	35K	35P	36H
Wheelbase (inches)	208"	228"	228"	242"	208"	228"	252"	242"
Front GAWR (lbs) ²	8,000	8,000	8,000	8,000	8,000	8,000	9,000	9,000
Rear GAWR (lbs) ²	15,000	15,000	15,000	15,000	15,000	15,000	15,500	15,500
GCWR (lbs) ³	26,000	26,000	26,000	26,000	26,000	26,000	30,000	30,000
Hitch Rating Weight (lbs) [†]	5,000	5,000	5,000	5,000	5,000	5,000	5,000	5,000
Tongue Weight (lbs)*	500	500	500	500	500	500	500	500
Fuel Capacity (gal)	80	80	80	80	80	80	80	80

FORD® CHASSIS

Model: Ford

Engine: 6.8L Triton V10

Transmission: Ford 6-Speed, Automatic w/Overdrive

Alternator: 175 Amp

Torque: 460 lb.-ft. @ 3,000 RPM

Horsepower: 320 HP @ 3,900 RPM

DIMENSIONS & CAPACITIES

MODEL	VACATIONER XE				VACATIONER			
	32A	34S	36D	36F	33C	35K	35P	36H
Overall Length (inches) ⁴	34' 8"	36' 2"	36' 2"	38' 8"	33' 8"	35' 8"	35' 8"	37'
Overall Height with A/C)	12	12	12	12	12' 10"	12' 10"	12' 10"	12' 10"
Overall Width (maximum) ^{5, 6}	102"	102"	102"	102"	102"	102"	102"	102"
Interior Height (maximum)	82"	82"	82"	82"	84"	84"	84"	84"
Interior Width (maximum)	96"	96"	96"	96"	96"	96"	96"	96"
Patio Awning Width	18'	18'	18'	18"	17'	17'	15'	17'
Interior Storage (cu. ft.)	142	150	204	171	123	126	144	146
Exterior Storage (cu. ft.)	151	160	106	139	160	180	138	170
Fresh Water Holding Tank (gal)	60	60	60	60	100	100	100	100
Grey Water Holding Tank (gal)	37	37	37	80	58	58	46	58
Black Water Holding Tank (gal)	37	37	37	37	42	42	30	42
Appliance Propane Tank (gal) (WC) ⁷	14	14	14	14	14	25	25	25
Water Heater Tank (gal)	10	10	10	10	10	10	10	10

This is living.

At Holiday Rambler, your dream journey is our unwavering inspiration. Whether you're planning a rambling weekend getaway or imagining a cross-country holiday adventure, we know that owning a motorhome is a dream lifestyle. We take that dream seriously. **We focus on the idea of home — not the place, but the feeling.** Then we make sure to turn that feeling into one of the most envious getaways. Holiday Rambler. This is living...



HOLIDAY RAMBLER®

YOUR LOCAL DEALER



REV GROUP

Holiday Rambler is part of REV Recreation Group, a division of REV Group, Inc., a family of 26 industry-leading motor vehicle brands. At REV Group, we innovate, design and build products that connect and protect thousands of people every day—our trusted vehicles are engineered with the utmost rigor and precision to deliver the highest levels of performance, reliability, durability and safety.

DISCLAIMER

1. GVWR (Gross Vehicle Weight Rating) is the maximum permissible weight of this fully loaded motorhome. The GVWR is equal to or greater than the sum of the (UVW) unloaded vehicle weight plus the (OCCC) occupant cargo-carrying capacity*.
 2. GAWR (Gross Axle Weight Rating) is the maximum permissible loaded weight a specific axle is designed to carry.
 3. GCWR (Gross Combined Weight Rating) is the value specified by the motorhome manufacturer as the maximum allowable loaded weight of this motorhome with its towed vehicle. Towing and braking capacities may be different. Refer to Holiday Rambler and chassis manufacturer's manuals for complete information.
 4. Length measured from front bumper to rear bumper (excludes accessories).
 5. Excludes safety equipment and awnings.
 6. Motorhomes feature a body width over 96" which will restrict your access to certain roads. Before purchasing, you should research any state and/or province road laws which may affect your usage.
 7. Tank manufacturer's listed water capacity (WC). Actual propane capacity is 80% of water listing as required by the safety code.
- * The chassis manufacturer recommends the installation of a supplemental brake control system to activate the brakes on the vehicle or trailer you are towing. Hitch receiver ratings expressed are maximum for the hitch receiver installed and may require the purchase of additional equipment that is dependent on the weight of the towed load. Consult with hitch receiver manufacturer for further information.
- ** UVW and OCCC are found on the label containing the federal certification tag in each RV.
- *** The Minimum Towable Load of this vehicle is the available weight capacity, up to GCWR, when the coach is fully loaded to maximum GVWR. However, if the coach is loaded to something less than maximum GVWR, that extra available weight capacity can be added to your Towable Load. For example, if your coach is loaded to 1000lbs less than maximum GVWR, your Towable Load increases accordingly. Do not exceed the hitch rating weight, GVWR or GCWR.
- *** Seatbelts and locations are shown in the brochure for display purposes only. Actual numbers and locations will vary by model.
- *** All 2017 REV Recreation Group motorhomes include a limited one-year/15,000-mile coach warranty and three-year/45,000-mile structural warranty, whichever occurs first, and is fully transferable for the first 12 months.

CONTACT US

To locate a dealer near you, visit our website at www.holidayrambler.com or call 1-877-252-4666. We can also be contacted at Holiday Rambler Customer Relations, P.O. Box 1007, Decatur, IN 46733.

IMPORTANT—PLEASE READ: Product information, photography and illustrations included in this publication were as accurate as possible at the time of printing. For further product information and changes, please visit our website at www.holidayrambler.com or contact your local Holiday Rambler dealer. Prices, materials, design and specifications are subject to change without notice. All weights, fuel, liquid capacities and dimensions are approximate. Holiday Rambler has designed its recreational vehicles to provide a variety of uses for customers. Each vehicle features optimal seating, sleeping, storage and fluid capacities. The user is responsible for selecting the proper combination of loads (i.e., occupants, equipment, fluids, cargo, etc.) to ensure that the vehicle's capacities are not exceeded.

www.holidayrambler.com

©2017 REV Group, Inc. Printed in the USA. Inventory Control Number VACVACXE18B1, 05/17. Model Year 2018, First Edition.



HOLIDAY RAMBLER®

DREAM LIFESTYLE | FAMILY AMENITIES | FULL-TIME FUN

www.holidayrambler.com

VACATIONER

2018.5 HOLIDAY RAMBLER CLASS A GAS



OUR VEHICLES CONNECT AND PROTECT
PEOPLE AROUND THE WORLD EVERYDAY.
www.revgroup.com



FLOORPLANS

33C

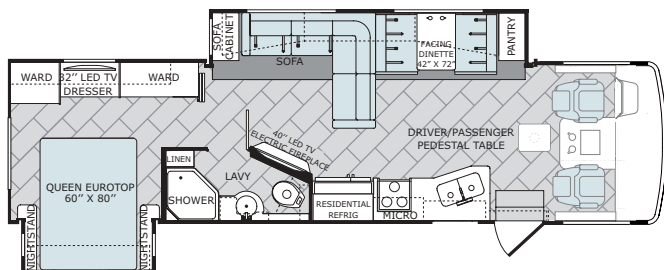

AVAILABLE OPTIONS: 113, 126, 194, 220, 833

34S

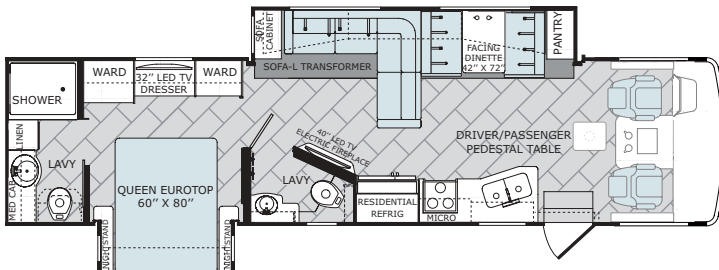

AVAILABLE OPTIONS: 113, 126, 194, 220, 833

35K

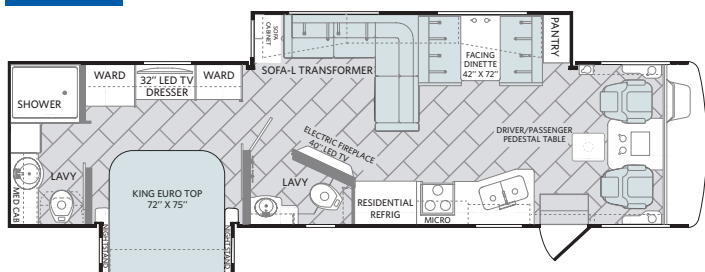

AVAILABLE OPTIONS: 113, 126, 194, 220, 833

35P

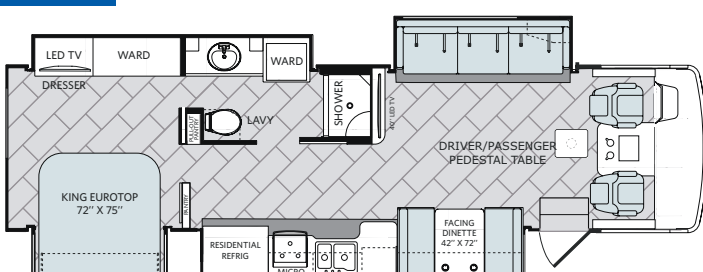

AVAILABLE OPTIONS: 113, 131, 208, 220, 833

36D

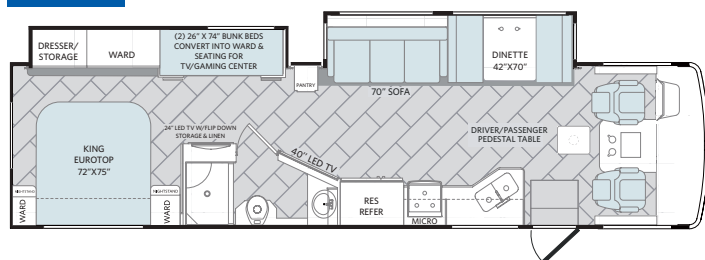

AVAILABLE OPTIONS: 113, 194, 220, 833

36F

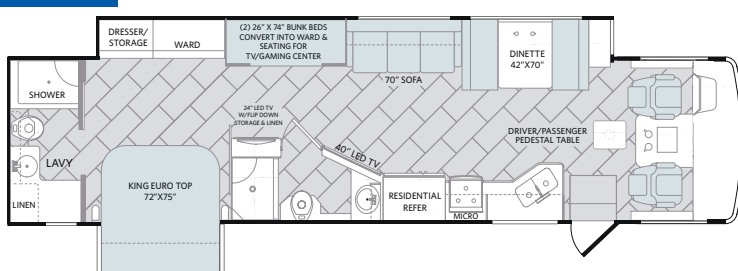

AVAILABLE OPTIONS: 110, 113, 126, 194, 220

EXTERIOR OPTIONS



Celestial



Harbor



Spectrum

IMPORTANT—PLEASE READ: Product information, photography and illustrations included in this publication were as accurate as possible at the time of printing. For further product information and changes, please visit our website at www.holidayrambler.com or contact your local Holiday Rambler dealer. Prices, materials, design and specifications are subject to change without notice. All weights, fuel, liquid capacities and dimensions are approximate. Holiday Rambler has designed its recreational vehicles to provide a variety of uses for its customers. Each vehicle features optimal seating, sleeping, storage and fluid capacities. The user is responsible for selecting the proper combination of loads (i.e., occupants, equipment, fluids, cargo, etc.) to ensure that the vehicle's capacities are not exceeded.

©2017 REV Group Inc. Printed in USA. Inventory Control Number VACATIONER_SalesWN18S1, 03/17. Model Year 2018, First Edition.

DECOR

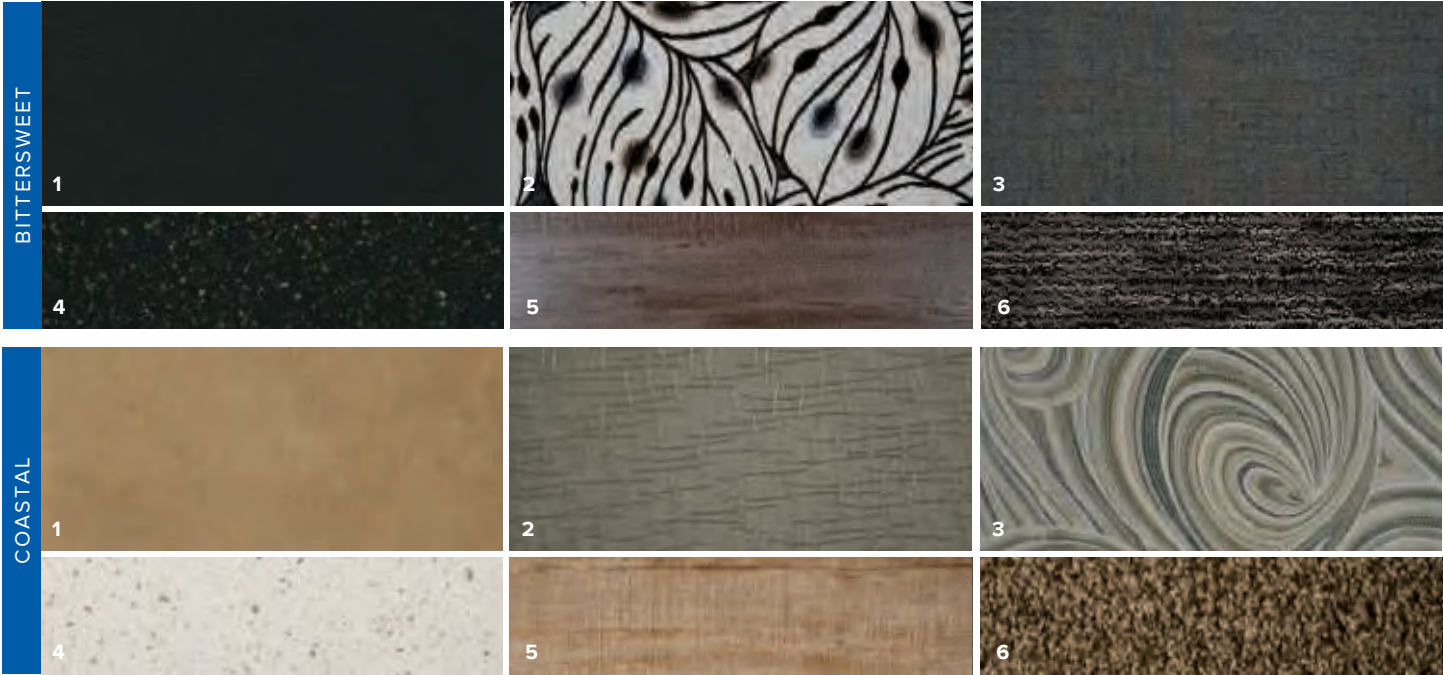

1 SOFA 2 LIVING ACCENT 3 BEDSPREAD 4 COUNTERTOP 5 FLOORING 6 CARPET



YOUR LOCAL DEALER



HOLIDAY RAMBLER®

WEIGHTS & MEASURES

MODEL	33C	34S	35K	35P	36D	36F
Wheelbase (inches)	208"	228"	228"	252"	228"	242"
Front GAWR (lbs) ²	8,000	8,000	8,000	9,000	8,000	8,000
Rear GAWR (lbs) ²	15,000	15,000	15,000	15,500	15,000	15,000
GCWR (lbs) ³	26,000	26,000	26,000	30,000	26,000	26,000
Hitch Rating Weight (lbs) ⁴	5,000	8,000	5,000	5,000	8,000	8,000
Tongue Weight (lbs) [*]	500	500	500	500	500	500
Fuel Capacity (gal)	80	80	80	80	80	80

FORD® CHASSIS

Model: Ford

Engine: 6.8L Triton V10

Transmission: Ford 6-Speed, Automatic w/Overdrive

Alternator: 175 Amp

Torque: 460 lb.-ft. @ 3,000 RPM

Horsepower: 320 HP @ 3,900 RPM

DIMENSIONS & CAPACITIES

MODEL	33C	34S	35K	35P	36D	36F
Overall Length (inches) ¹	34' 3"	36' 3"	36' 3"	36' 3"	36' 3"	38' 9"
Overall Height with A/C)	12' 10"	12' 10"	12' 10"	12' 10"	12' 10"	12' 10"
Overall Width (maximum) ^{5,6}	102"	102"	102"	102"	102"	102"
Interior Height (maximum)	84"	84"	84"	84"	84"	84"
Interior Width (maximum)	96"	96"	96"	96"	96"	96"
Patio Awning Width	18'	18'	18'	15'	18'	18'
Interior Storage (cu. ft.)	123	150	126	144	204	171
Exterior Storage (cu. ft.)	160	148	180	138	130	170
Fresh Water Holding Tank (gal)	100	100	100	100	100	100
Grey Water Holding Tank (gal)	58	45	58	46	45	90
Black Water Holding Tank (gal)	42	50	42	30	50	50
Appliance Propane Tank (gal) (WC) ⁷	25	25	25	25	25	25
Water Heater Tank (gal)	10	10	10	10	10	10



Holiday Rambler is part of REV Recreation Group, a division of REV Group, Inc., a family of 29 industry-leading motor vehicle brands. At REV Group, we innovate, design and build products that connect and protect thousands of people every day—our trusted vehicles are engineered with the utmost rigor and precision to deliver the highest levels of performance, reliability, durability and safety.

DISCLAIMER

1. GVWR (Gross Vehicle Weight Rating) is the maximum permissible weight of this fully loaded motorhome. The GVWR is equal to or greater than the sum of the (UVW) unloaded vehicle weight plus the (OCCC) occupant cargo-carrying capacity*.

2. GAWR (Gross Axle Weight Rating) is the maximum permissible loaded weight a specific axle is designed to carry.

3. GCWR (Gross Combined Weight Rating) is the value specified by the motorhome manufacturer as the maximum allowable loaded weight of this motorhome with its towed vehicle. Towing and braking capacities may be different. Refer to Holiday Rambler and chassis manufacturer's manuals for complete information.

4. Length measured from front bumper to rear bumper (excludes accessories).

5. Excludes safety equipment and awnings.

6. Motorhomes feature a body width over 96" which will restrict your access to certain roads. Before purchasing, you should research any state and/or province road laws which may affect your usage.

7. Tank manufacturer's listed water capacity (WC). Actual propane capacity is 80% of water listing as required by the safety code.

* The chassis manufacturer recommends the installation of a supplemental brake control system to activate the brakes on the vehicle or trailer you are towing. Hitch receiver ratings expressed are maximum for the hitch receiver installed and may require the purchase of additional equipment that is dependent on the weight of the towed load. Consult with hitch receiver manufacturer for further information.

* UVW and OCCC are found on the label containing the federal certification tag in each RV.

** The Minimum Towable Load of this vehicle is the available weight capacity, up to GCWR, when the coach is fully loaded to maximum GVWR. However, if the coach is loaded to something less than maximum GVWR, that extra available weight capacity can be added to your Towable Load. For example, if your coach is loaded to 1000lbs less than maximum GVWR, your Towable Load increases accordingly. Do not exceed the hitch rating weight, GVWR or GCWR.

*** Seatbelts and locations are shown in the brochure for display purposes only. Actual numbers and locations will vary by model.

*** All 2017 REV Recreation Group motorhomes include a limited one-year/15,000-mile coach warranty and three-year/45,000-mile structural warranty, whichever occurs first, and is fully transferable for the first 12 months.

CONTACT US

To locate a dealer near you, visit our website at www.holidayrambler.com or call 1-877-252-4666. We can also be contacted at Holiday Rambler Customer Relations, P.O. Box 1007, Decatur, IN 46733.

IMPORTANT—PLEASE READ: Product information, photography and illustrations included in this publication were as accurate as possible at the time of printing. For further product information and changes, please visit our website at www.holidayrambler.com or contact your local Holiday Rambler dealer. Prices, materials, design and specifications are subject to change without notice. All weights, fuel, liquid capacities and dimensions are approximate. Holiday Rambler has designed its recreational vehicles to provide a variety of uses for customers. Each vehicle features optimal seating, sleeping, storage and fluid capacities. The user is responsible for selecting the proper combination of loads (i.e., occupants, equipment, fluids, cargo, etc.) to ensure that the vehicle's capacities are not exceeded.

www.holidayrambler.com

©2017 REV Group, Inc. Printed in the USA. Inventory Control Number VAC18F1, 10/17. Model Year 2018, First Edition.